

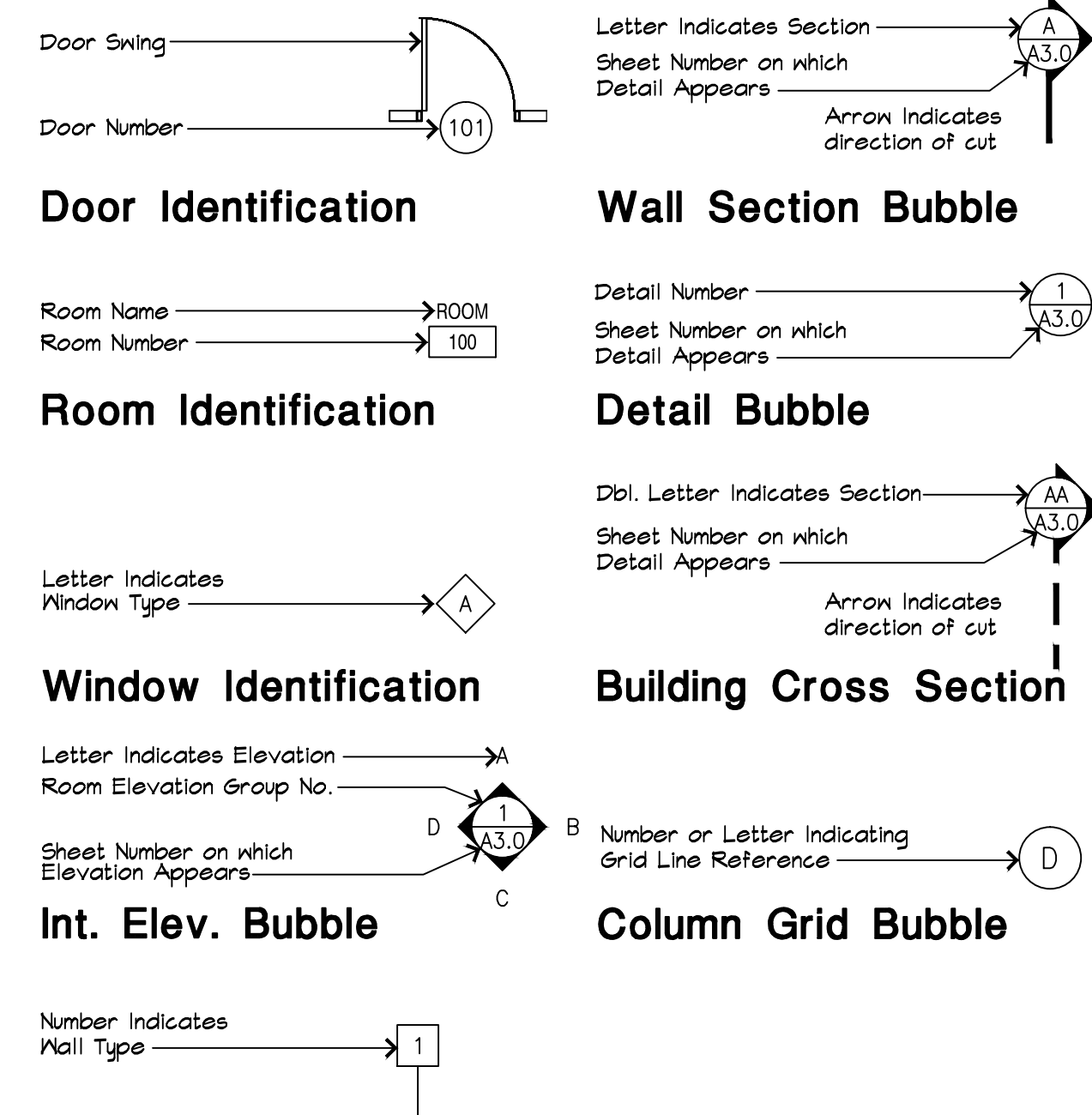

Exterior Renovation of the Hea Residence - 61 Glenmoor Drive

Cherry Hills Village, Colorado

SYMBOLS LEGEND



MATERIALS LEGEND

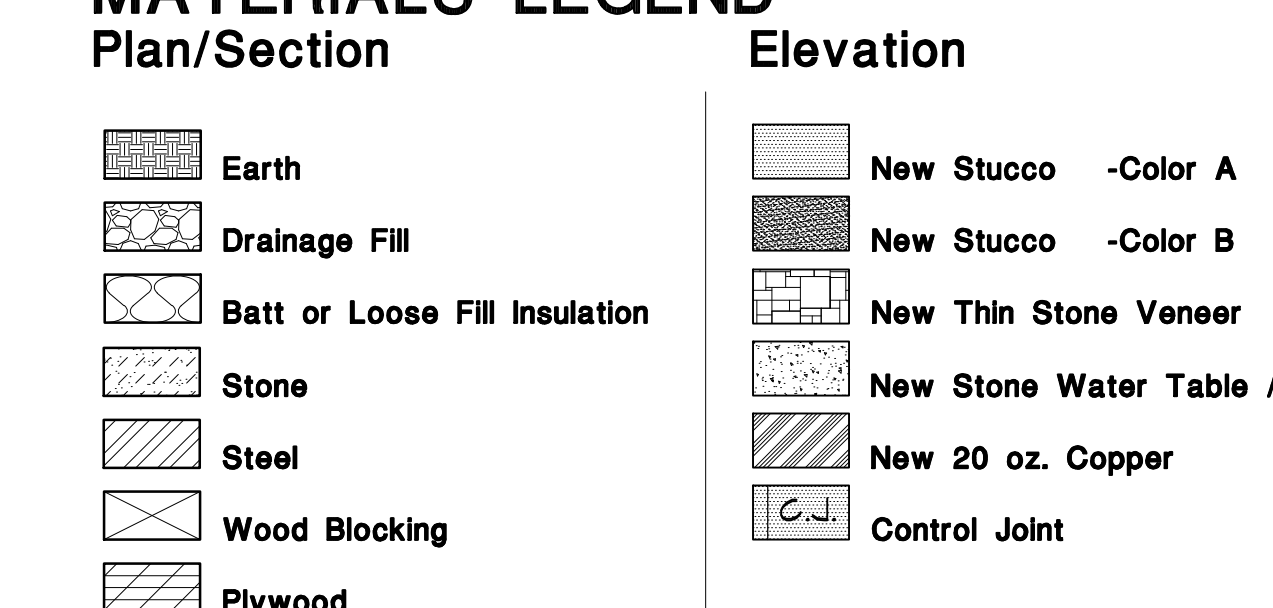

LIST OF ABBREVIATIONS

ATG	ACQUISITORY TILE CEILING	KIT.	KITCHEN
ADJ.	ADJUSTABLE	LEN.	LENGTH
ADJ.F.	ADJUSTABLE FINISHED FLOOR	LAB.	LABORATORY
ALUM.	ALUMINUM	LAM.	LAMINATE
ALT.	ALTERNATE	LAV.	LAVATORY
APPROX.	APPROXIMATE	L.F.	LINEAL FEET
ARCH.	ARCHITECT/ARCHITECTURAL	LD.	LOAD
ANGD.	ANGLED	LVR.	LOUVER
APPROV.	APPROVED	MAS.	MASONRY OPENING
BD.	BOARD	MATL.	MATERIAL
BLDG.	BUILDING	MAX.	MAXIMUM
BLK.	BLOCK	MECH.	MECHANICAL
BLKS.	BLOCKING	MD.	MEDIUM
B.M.	BENCH MARK	MFR.	MANUFACTURER
BOT.	BOTTOM	M.H.	MANHOLE
B.O.	BOTTOM OF	MIN.	MINIMUM
BRG.	BEARING	MISC.	MISCELLANEOUS
BSMT.	BASEMENT	MM.	MILLIMETER(S)
BUR.	BUILT UP ROOF	MTL.	METAL
CTR.	CENTER, CENTERED	N.	NORTH
CIR.	CIRCLE	NEG.	NECESSARY
CIRC.	CIRCUMFERENCE	N.C.	NOT IN CONTRACT
C.J.	CONTROL JOINT	NO.	NUMBER
CLB.	CEILING	NDM.	NOMINAL
CLN.	CLEAN	N.T.S.	NOT TO SCALE
CMU.	CONCRETE MASONRY UNITS	O.D.	OUTSIDE DIAMETER
COL.	COLUMN	O.C.	ON CENTER
COMB.	COMBINATION	OH.	OVERHEAD
COMP.	COMPACT, COMPACTED	OPN.	OPENING
CONC.	CONCRETE	OPP.	OPPOSITE
CONT.	CONTINUOUS	O.S.B.	ORIENTED STRAND BOARD
CONTR.	CONSTRUCTION	PART.	PARTICLE
COORD.	COORDINATE	PER.	PERIMETER
CORR.	CORROSION	PLAM.	PLASTIC LAMINATE
CPT.	CARPET	PROP.	PROPERTY
C.TILE.	CERAMIC TILE	PT.	PAINT
D.	DEEP, DRYER	P.TILE.	PORCELAIN TILE
DBL.	DOUBLE	Q.TILE.	QUARRY TILE
DEMO.	DEMOLITION	R.	RISER, RADIUS
DEPT.	DEPARTMENT	RB.	RUBBER BASE
D.F.	DRINKING FOUNTAIN	RE.	REFER TO
DIA.	DIAGONAL	REG.	REGRESSED
DIA.	DIAMETER	REF.	REFERENCE
DIM.	DIMENSION	REFL.	REFLECTED
DISP.	DISPENSER	REM.	REMOVE, REMOVABLE
DISP.	DISPOSAL	REQD.	REQUIRED
DIV.	DIVISION	RET.	RETURN
DN.	DOWN	REV.	REVISION
DR.	DOOR	RM.	ROOM
D.S.	DOWN SPOUT	S.	SOUTH
DWG.	DRAWING	S.B.	SPLASH BLOCK
E.	EAST	SCHED.	SCHEDULE
EA.	EACH	SECT.	SECTION
ELEC.	ELECTRIC	S.F.	SQUARE FOOT
ELEV.	ELEVATION, ELEVATOR	SHR.	SHOWER
EQ.	EQUAL	SHT.	SHEET
EQMT.	EQUIPMENT	SIM.	SIMILAR
EAC.	ELECTRIC WATER COOLER	SOB.	SLAB-ON-GRADE
EXH.	EXHAUST	SPEC.	SPECIFICATION
EXIST.	EXISTING	SPECS.	SPECIFICATIONS
ETR.	EXIST. TO REMAIN	SPEK.	SPEAKER
EXT.	EXTERIOR	SO.	SQUARE
EXP.	EXPANSION JOINT	STD.	STANDARD
E.J.	EXPANSION JOINT	STL.	STEEL
F.D.	FLOOR DRAIN	STR.	STRAP
F.E.	FIRE EXTINGUISHER	STRUC.	STRUCTURE, STRUCTURAL
F.F.E.	FINISH FLOOR ELEVATION	SUSP.	SUSPENDED
FIN.	FINISHED	SYN.	SYMMETRICAL
FLK.	FLOOR	SYS.	SYSTEM
FLX.	FLEXURE	T.	THICK, TREAD
FND.	FOUNDATION	T.B.D.	TO BE DETERMINED
F.R.	FIRE RATED	TEMP.	TEMPERARY, TEMPERED
FRMG.	FRAMING	T&G.	TONGUE AND GROOVE
FRZ.	FREEZER	T.O.	TOP OF (EG. STEEL)
FTS.	FOOTING	TLT/TOL.	TOILET
FUT.	FUTURE	T.P.	TOILET PAPER
GA.	GAGE	T.S.	TUBE STEEL
GALV.	GALVANIZED	TY.	TYPICAL
GB.	GRAB BAR	UNO.	UNDERCUT
GRND.	GROUND	UNO.	UNLESS NOTED OTHERWISE
GS.	GENERAL CONTRACTOR	V.B.	VAPOR BARRIER
GYP. BD.	GYP. BOARD	V.C.T.	VINTL. COMPOSITION TILE
H.	HIGH	VENT.	VENTILATOR
H.B.	HOSE BIBB	VERT.	VERTICAL
HC.	HANDICAPPED	VEST.	VESTIBULE
HD.	HEAVY DUTY	VIN.	VINYL
HWY.	HARDWARE	W.	WIDE, WEST, WASHER
HM.	HOLLOW METAL	W/O.	WITHOUT
H.O.	HOLD OPEN	W.C.	WATER CLOSET
HORZ.	HORIZONTAL	W.D.	WOOD
HT.	HEIGHT	WDL.	WINDOW
HTG.	HEATING	WN.	WINDON
I.D.	INSIDE DIAMETER	WR.	WATER RESISTANT
INCL.	INCLUDE, INCLUDING	W.S.C.	WANSICOT
INSUL.	INSULATION, INSULATED	WNT.	WELDED WIRE FABRIC
INT.	INTERIOR		
JT.	JOINT		
JST.	JOIST		

INDEX TO DRAWINGS

ARCHITECTURAL	
A1.0	Demolition Plan & Exterior Elevations
A2.0	Site Plan & Exterior Elevations
A3.0	Door & Window Frame & Trim Types, & Details
A4.0	Details
A4.1	Enlarged Deck Plan, Framing Plan, & Details
A5.0	

VICINITY MAP

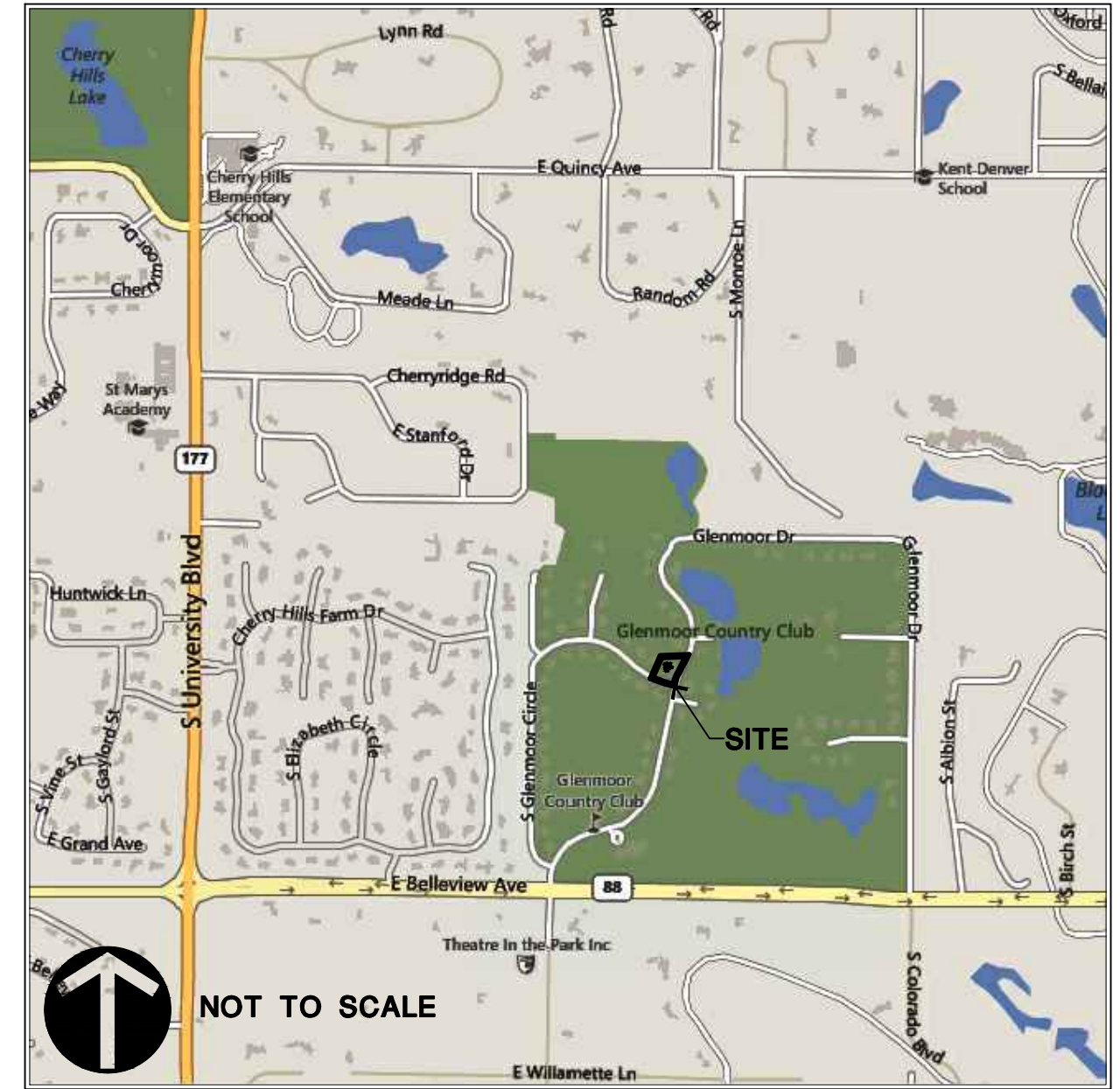

BUILDING INFORMATION

Address: 61 Glenmoor Drive
Cherry Hills Village, Colorado 80113

Site Area: 1 acre

SCOPE OF WORK

- The scope of work shall include the following:
- Replacement of the existing EIFS veneer with an adhered stone-veneer system and hard-coat stucco.
 - Addition of soffit vents.
 - Replacement and enlargement of rear exterior deck.
 - Exterior painting.
 - Replacement of selected doors (including garage).
 - Replacement and addition of light fixtures.
 - Minor landscape repair.
 - Addition of additional attic insulation.

Owner:
Robert Hea
61 Glenmoor Drive
Cherry Hills Village, Colorado 80113

Architects:
Eidos Architects, PC
5400 Greenwood Plaza Blvd.
Greenwood Village, CO 80111
Phone: 720-200-0630
Fax: 720-200-0631

Structural Engineers:
McGlarmey Structural Group
3734 Osage Street
Denver, Colorado 80211
Phone: 303-455-8988 Fax: 303-455-8446